

# Φ5 Round Type LED, Viewing Angle 20

Outline Dimensions (mm)

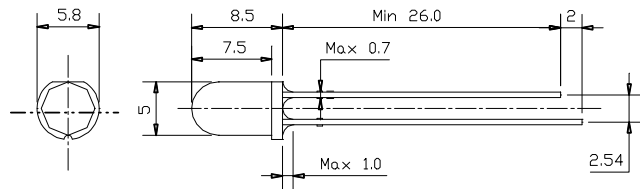

Absolute Maximum Ratings

Parameter	Symbol	Ratings					Unit
		White, Pink	Blue	Pure Green	Red, Orange	Yellow	
Forward Current	If	30	30	30	50	50	mA
Power Dissipation	Pd	120	120	120	125	125	mW
Pulsed Forward Current *	Ifp	100	100	100	100	100	mA
Reverse Voltage	Vr	5	5	5	5	5	V
Operating Temperature	Topr	-25~80	-25~80	-25~80	-35~80	-35~80	C
Storage Temperature	Tstg	-30~100	-30~100	-30~100	-30~100	-30~100	C

\*Pulse Width 10msec Duty 1/10

Optical-Electrical Characteristics

Model No.	Luminous Intensity (mcd)			Forward Voltage (V)			Reverse Current (μA)		Wavelength (nm)		
	Typ.	Min.	If(mA)	Typ.	Max	If(mA)	Max.	Vr(V)	λd Min.	λd Max.	If(mA).
LED-WH-510CWU	5500	4500	20	3.5	4.0	20	50	5	X:0.31	Y:0.32	20
LED-PI-510CWS	1400	900	20	3.5	4.0	20	50	5	X:0.38	Y:0.18	20
LED-BL-510CWH	1400	900	20	3.5	4.0	20	50	5	465	475	20
LED-BL-510CWU	2200	1500	20	3.5	4.0	20	50	5	465	475	20
LED-PG-510CWU	5500	3800	20	3.5	4.0	20	50	5	520	530	20
LED-AM-510CWH	2800	2300	20	2.1	2.4	20	50	5	586	596	20
LED-AM-510CWS	5500	4500	20	2.1	2.4	20	50	5	586	596	20
LED-AM-510CWU	9000	7500	20	2.2	2.5	20	50	5	586	596	20
LED-OR-510CWH	2800	2300	20	2.1	2.4	20	50	5	619	629	20
LED-OR-510CWS	5500	4500	20	2.1	2.4	20	50	5	619	629	20
LED-OR-510CWU	9000	7500	20	2.2	2.5	20	50	5	619	629	20

## Φ5 Round Type LED, Viewing Angle 40

Outline Dimensions (mm)

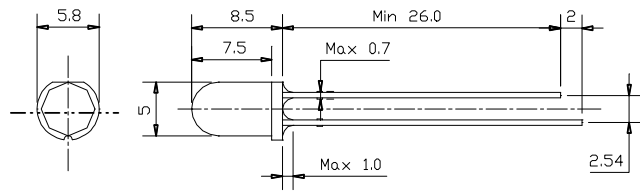

Absolute Maximum Ratings

Parameter	Symbol	Ratings					Unit
		White	Blue	Pure Green	Red, Orange	Yellow	
Forward Current	If	30	30	30	50	50	mA
Power Dissipation	Pd	120	120	120	125	125	mW
Pulsed Forward Current *	Ifp	100	100	100	100	100	mA
Reverse Voltage	Vr	5	5	5	5	5	V
Operating Temperature	Topr	-25~80	-25~80	-25~80	-35~80	-35~80	C
Storage Temperature	Tstg	-30~100	-30~100	-30~100	-30~100	-30~100	C

\*Pulse Width 10msec Duty 1/10

Optical-Electrical Characteristics

Model No.	Luminous Intensity (mcd)			Forward Voltage (V)			Reverse Current (μA)		Wavelength (nm)		
	Typ.	Min.	If(mA)	Typ.	Max	If(mA)	Max.	Vr(V)	λd Min.	λd Max.	If(mA).
LED-WH-520CWU	4000	2200	20	3.5	4.0	20	50	5	X:0.31	Y:0.32	20
LED-BL-520CWH	1000	600	20	3.5	4.0	20	50	5	465	475	20
LED-BL-520CWU	1600	1000	20	3.5	4.0	20	50	5	465	475	20
LED-PG-520CWU	3500	2500	20	3.5	4.0	20	50	5	520	530	20
LED-BG-520CWU	3000	2000	20	3.5	4.0	20	50	5	500	510	20
LED-AM-520CWH	2000	1500	20	2.1	2.4	20	50	5	586	596	20
LED-AM-520CWS	4000	3000	20	2.1	2.4	20	50	5	586	596	20
LED-AM-520CWU	6000	4500	20	2.2	2.5	20	50	5	586	596	20
LED-OA-520CWS	4000	3000	20	2.1	2.4	20	50	5	600	610	20
LED-OR-520CWH	2000	1800	20	2.1	2.4	20	50	5	619	629	20
LED-OR-520CWS	4000	3000	20	2.1	2.4	20	50	5	619	629	20
LED-OR-520CWU	6000	4500	20	2.2	2.5	20	50	5	619	629	20

# Φ5 Cylindrical Type LED, Viewing Angle 140

Outline Dimensions (mm)

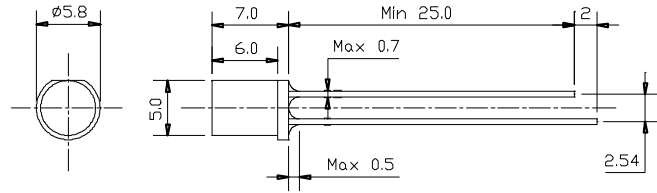

Absolute Maximum Ratings

Parameter	Symbol	Ratings					Unit
		White	Blue	Pure Green	Red, Orange	Yellow	
Forward Current	If	30	30	30	50	50	mA
Power Dissipation	Pd	120	120	120	125	125	mW
Pulsed Forward Current *	Ifp	100	100	100	100	100	mA
Reverse Voltage	Vr	5	5	5	5	5	V
Operating Temperature	Topr	-25~80	-25~80	-25~80	-35~80	-35~80	C
Storage Temperature	Tstg	-30~100	-30~100	-30~100	-30~100	-30~100	C

\*Pulse Width 10msec Duty 1/10

Optical-Electrical Characteristics

Model No.	Luminous Intensity (mcd)			Forward Voltage (V)			Reverse Current (μA)		Wavelength (nm)		
	Typ.	Min.	If(mA)	Typ.	Max	If(mA)	Max.	Vr(V)	λd Min.	λd Max.	If(mA).
LED-WH-570FWU	300	180	20	3.5	4.0	20	50	5	X:0.31	Y:0.32	20
LED-BL-570FWH	140	100	20	3.5	4.0	20	50	5	465	475	20
LED-BL-570FWU	220	150	20	3.5	4.0	20	50	5	465	475	20
LED-PG-570FWU	480	330	20	3.5	4.0	20	50	5	520	530	20
LED-AM-570FWH	230	150	20	2.1	2.4	20	50	5	586	596	20
LED-AM-570FWS	300	200	20	2.1	2.4	20	50	5	586	596	20
LED-AM-570FWU	550	400	20	2.2	2.5	20	50	5	586	596	20
LED-OR-570FWH	180	130	20	2.1	2.4	20	50	5	619	629	20
LED-OR-570FWS	250	170	20	2.1	2.4	20	50	5	619	629	20
LED-OR-570FWU	520	400	20	2.2	2.5	20	50	5	619	629	20

# Φ3 Round Type LED, Viewing Angle 40

## Outline Dimensions (mm)

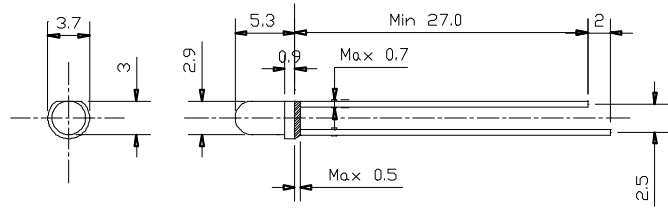

## Absolute Maximum Ratings

Parameter	Symbol	Ratings					Unit
		White	Blue	Pure Green	Red	Yellow	
Forward Current	If	30	30	30	50	50	mA
Power Dissipation	Pd	120	120	120	125	125	mW
Pulsed Forward Current *	Ifp	100	100	100	100	100	mA
Reverse Voltage	Vr	5	5	5	5	5	V
Operating Temperature	Topr	-25~80	-25~80	-25~80	-35~80	-35~80	C
Storage Temperature	Tstg	-30~100	-30~100	-30~100	-30~100	-30~100	C

\*Pulse Width 10msec Duty 1/10

## Optical-Electrical Characteristics

Model No.	Luminous Intensity (mcd)			Forward Voltage (V)			Reverse Current (μA)		Wavelength (nm)		
	Typ.	Min.	If(mA)	Typ.	Max	If(mA)	Max.	Vr(V)	λd Min.	λd Max.	If(mA).
LED-WH-320CWU	4000	2200	20	3.5	4.0	20	50	5	X:0.31	Y:0.32	20
LED-BL-320CWH	1000	600	20	3.5	4.0	20	50	5	465	475	20
LED-BL-320CWU	1400	1000	20	3.5	4.0	20	50	5	465	475	20
LED-PG-320CWU	3300	2500	20	3.5	4.0	20	50	5	520	530	20
LED-AM-320CWH	2000	1500	20	2.1	2.4	20	50	5	586	596	20
LED-AM-320CWS	4000	3000	20	2.1	2.4	20	50	5	586	596	20
LED-AM-320CWU	6000	4500	20	2.2	2.5	20	50	5	586	596	20
LED-OR-320CWH	2000	1800	20	2.1	2.4	20	50	5	619	629	20
LOR-320CWS	4000	3000	20	2.1	2.4	20	50	5	619	629	20
LOR-320CWU	6000	4500	20	2.2	2.5	20	50	5	619	629	20

# SMD LED 1608 (0603), 0.4T, Viewing Angle 140

Outline Dimensions (mm)

ERROR: rangecheck  
OFFENDING COMMAND: .buildcmap

STACK:

-dictionary-  
/WinCharSetFFFF-V2TT621301FBt  
/CMap  
-dictionary-  
/WinCharSetFFFF-V2TT621301FBt